

Cambridge Brass  
P.O. Box 249  
140 Orion Place  
Cambridge, Ontario  
Canada N1R 5V1  
Tel: (519) 621-5520  
Fax: (519) 621-8674  
<http://www.cambridgebrass.com>

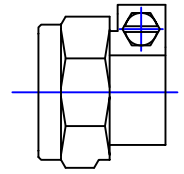

MODEL NO. 81

CAMPAK

CAMPAK  
NUT ASSEMBLY

FOR COPPER OR PLASTIC TUBING (CTS)

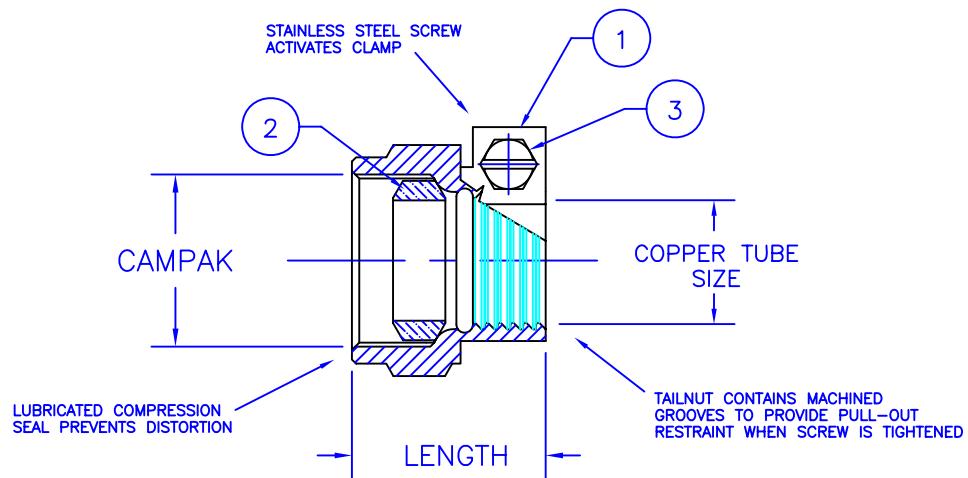

PARTS AND MATERIAL:  
1. TAILNUT: CAST BRASS, ALLOY C83600  
2. COMPRESSION SEAL: NITRILE RUBBER  
3. SCREW: STAINLESS STEEL, ALLOY 304

FEATURES:  
- MANUFACTURED IN COMPLIANCE WITH AWWA STANDARD C800-05  
(ASTM B-62 AND ASTM B-584, UNS NO C83600-85-5-5-5).

Cambridge Brass considers the information in this submittal form to be correct at the time of publication.  
Item and option availability, including specifications, are subject to change without notice.

CATALOG NO.	CAMPAK FOR CTS	LENGTH	APPROX. WT. LBS.
81-B1	1/2"	1.28"	0.3
81-B2	5/8"	1.28"	0.3
81-B3	3/4"	1.44"	0.3
81-B4	1"	1.65"	0.5
81-B5	1 1/4"	1.78"	0.7
81-B6	1 1/2"	2.10"	1.2
81-B7	2"	2.54"	1.7

Submitted by: