

Cambridge Brass  
P.O. Box 249  
140 Orion Place  
Cambridge, Ontario  
Canada N1R 5V1  
Tel: (519) 621-5520  
Fax: (519) 621-8674  
http://www.cambridgebrass.com

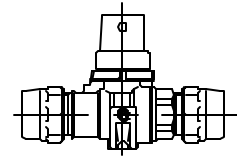

MODEL NO. 262

CB COMPRESSION x CB COMPRESSION

CURB STOP  
MINNEAPOLIS PATTERN

FOR COPPER OR PLASTIC TUBING (CTS)

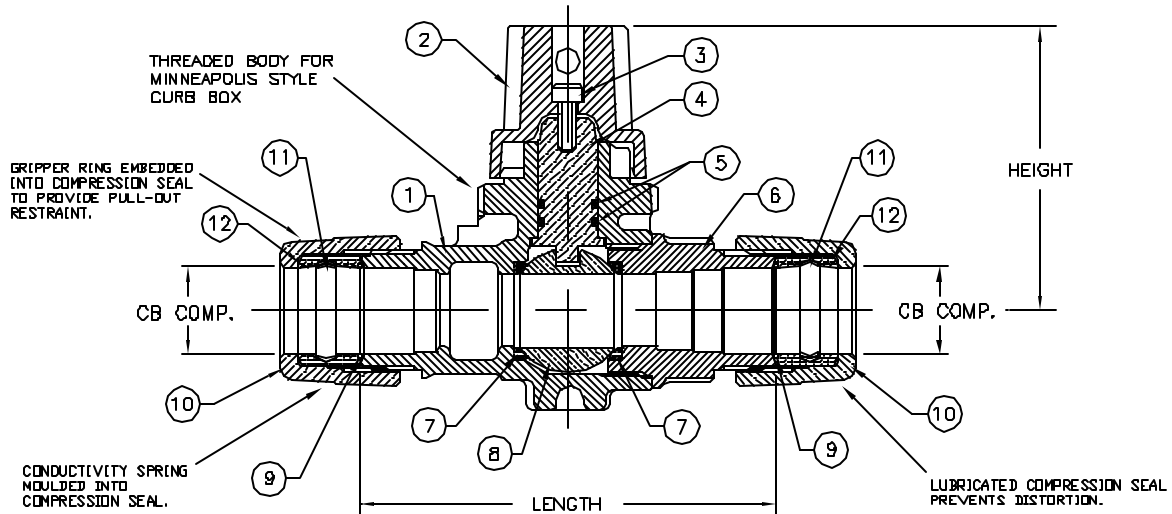

- PARTS AND MATERIAL:**
1. VALVE BODY: CAST BRASS, ALLOY CB3600
  2. CAP: CAST BRASS, ALLOY CB3600
  3. CAP SCREW: STAINLESS STEEL, TYPE 304
  4. STEM: STAINLESS STEEL, TYPE 303
  5. O-RING: NITRILE RUBBER
  6. ENDBODY: CAST BRASS, ALLOY CB3600
  7. SEATS: TEFLON
  8. BALL: CAST BRASS, ALLOY C89B33
  9. CONDUCTOR SPRING: BRASS
  10. TAILNUT: CAST BRASS, ALLOY CB3600
  11. GRIPPER: STAINLESS STEEL, TYPE 302
  12. COMPRESSION SEAL: NITRILE RUBBER

- FEATURES:**
- MANUFACTURED IN COMPLIANCE WITH AWWA STANDARD C800-05 (ASTM B-62 AND ASTM B-584, LINS NO C83600-85-5-5-5).
  - <X> CSA CLASSIFIED TO ANSI/NSF STANDARD 61-8.
  - FLOW CAN BE IN EITHER DIRECTION.
  - ROTATION STOPS RESISTS 200 FT-LB TORQUE.
  - ENCAPSULATED LUGS UNDER CAP PROVIDE 90 DEGREE OPEN TO CLOSE OPERATION.
  - HOLE FOR ATTACHING CURB BOX ROD OR HANDLE IS PROVIDED IN CAP.
  - BLOWOUT PROOF DESIGN.
  - 300 PSI WORKING PRESSURE.

**ORDERING INFORMATION:**  
FULL 360 ROTATION = ADD "R" TO END OF CATALOG NO.  
HANDLE = ADD "H" TO END OF CATALOG NO.

Cambridge Brass considers the information in this submittal form to be correct at the time of publication. Item and option availability, including specifications, are subject to change without notice.

VALVE SIZE	CATALOG NO.	CB COMP.	CB COMP.	LENGTH	HEIGHT	APPROX. WT. LBS.	CLASSIFIED NSF 61-8
3/4"	262-H3H3	3/4"	3/4"	4.35"	2.97"	3.0	<X>
1"	262-H4H4	1"	1"	4.95"	3.15"		<X>
1 1/2"	262-H6H6	1 1/2"	1 1/2"	6.56"	3.84"	10.0	<X>
2"	262-H7H7	2"	2"	6.83"	4.14"	12.9	

Submitted by: