

Cambridge Brass  
P.O. Box 249  
140 Orion Place  
Cambridge, Ontario  
Canada N1R 5V1  
Tel: (519) 621-5520  
Fax: (519) 621-8674  
http://www.cambridgebrass.com

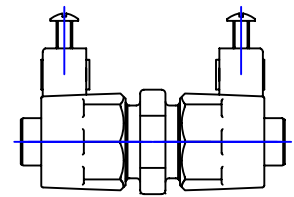

MODEL NO. 118

KITEC ELECTRICAL x  
KITEC ELECTRICAL

COUPLING  
WITH INTERNAL STOPS

FOR COPPER OR PLASTIC TUBING (CTS)

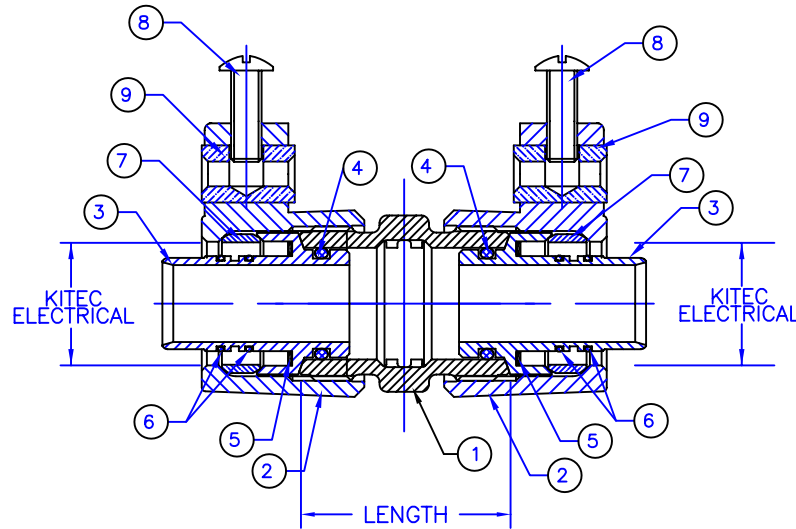

PARTS AND MATERIAL:

1. COUPLING BODY: CAST BRASS, ALLOY C83600
2. KITEC NUT: CAST BRASS, ALLOY C83600
3. INSERT: CAST BRASS, ALLOY C89833
4. O-RING: NITRILE RUBBER
5. INSULATOR: POLYETHYLENE
6. O-RING: NITRILE RUBBER
7. GRIPPER: BRASS, ALLOY C51000
8. SCREW: SILICON BRONZE
9. INSERT: COPPER, ALLOY C14500

FEATURES:

- MANUFACTURED IN COMPLIANCE WITH AWWA STANDARD C800-05 (ASTM B-62 AND ASTM B-584, UNS NO C83600-85-5-5-5).
- <X> CSA CLASSIFIED TO ANSI/NSF STANDARD 61-8.
- BODY DESIGN PROVIDES LARGE, RUGGED WRENCH FLATES FOR PROPER INSTALLATION.
- BODY PROVIDES INTERNAL TUBE STOP.

Cambridge Brass considers the information in this submittal form to be correct at the time of publication. Item and option availability, including specifications, are subject to change without notice.

CATALOG NO.	KITEC ELECTRICAL	KITEC ELECTRICAL	LENGTH	APPROX. WT. LBS.	CLASSIFIED NSF 61-8
118-KE3KE3	3/4"	3/4"	1.93"		
118-KE4KE4	1"	1"	2.12"		

Submitted by: